

DESIGN: Kato (HO2B)

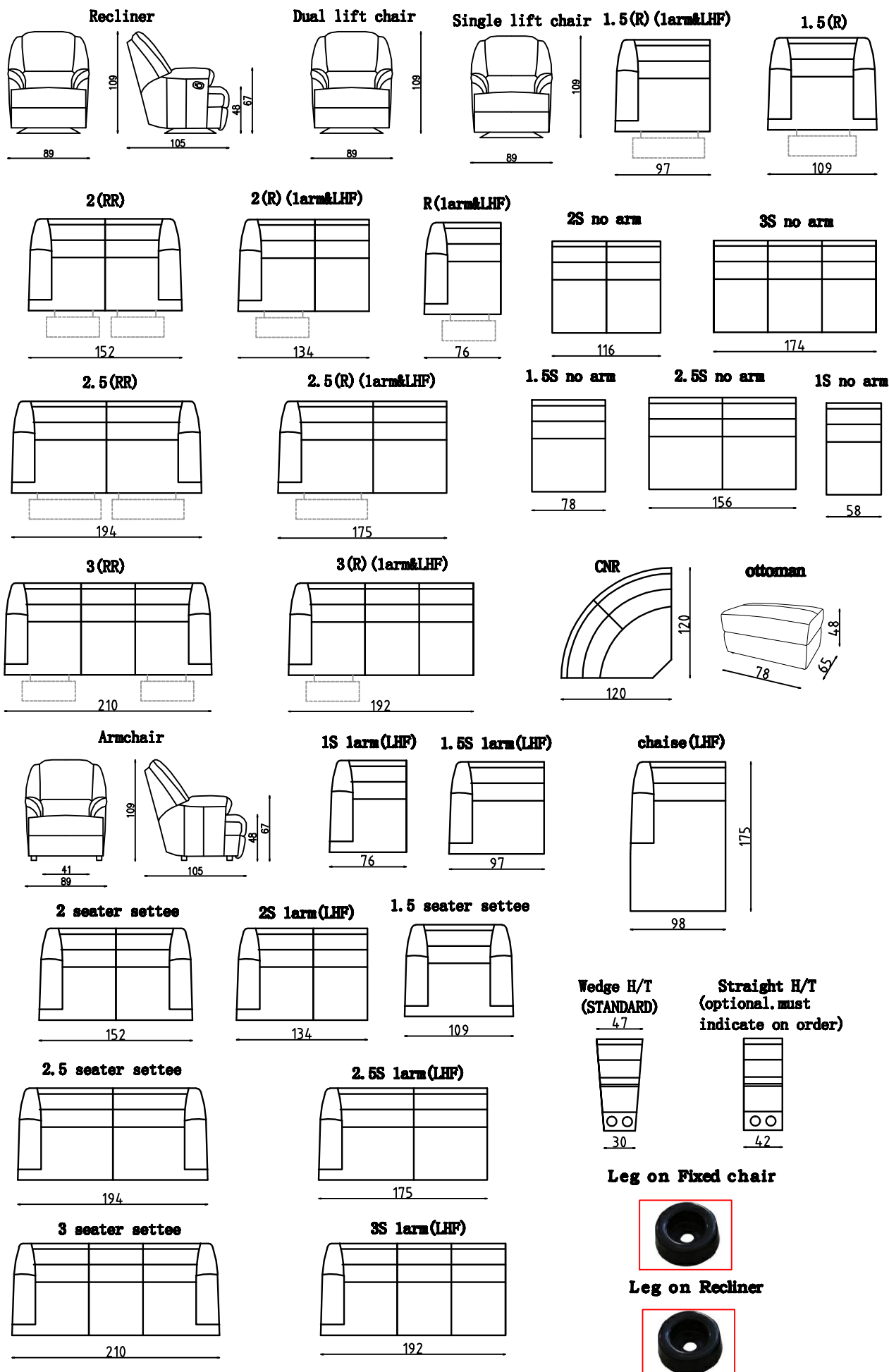

All pieces with 1 arm are available either LHF or RHF

2.5(R) (1arm&LHF) – CNR – 2.5(R) (1arm&RHF)

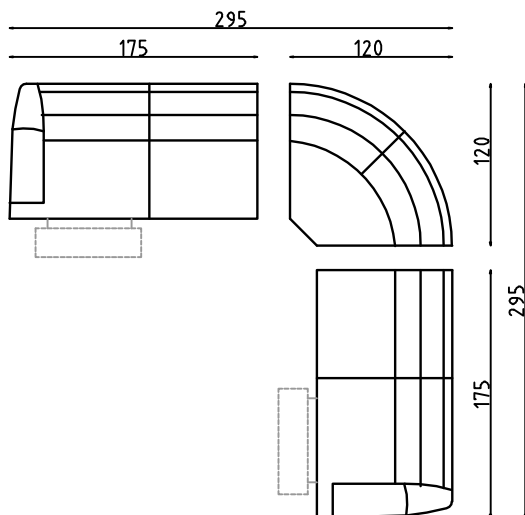

2(R) (1arm&LHF) – CNR – 2(R) (1arm&RHF)

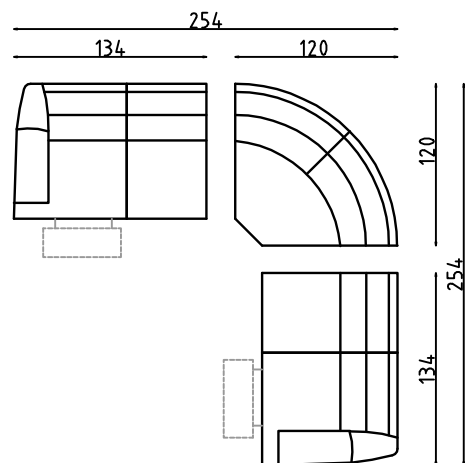

1.5(R) (1arm&LHF) – Wedge H/T – 1.5(R) (1arm&RHF)

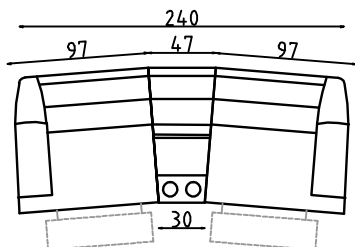

2.5(R) (1arm&LHF) – CNR – 1.5S(no arm) – 2.5(R) (1arm&RHF)

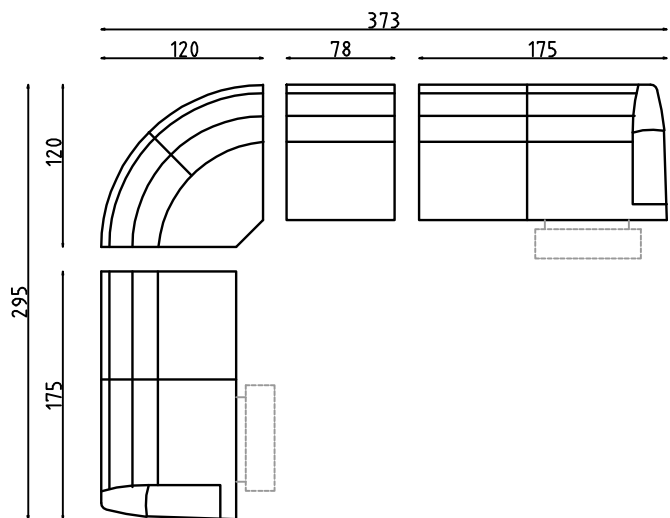

R(1arm&LHF) – Wedge H/T – R(1arm&RHF)

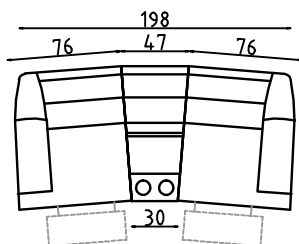

R(1arm&LHF) – Wedge H/T – R(no arm) – Wedge H/T – R(1arm&RHF)

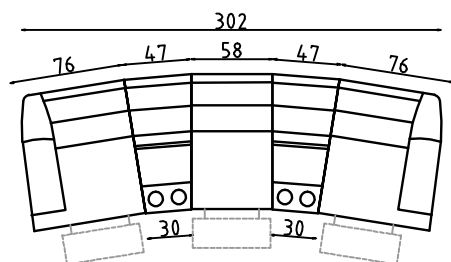

R(1arm&LHF) –H/T –R(no arm) –H/T –R(no arm)–H/T–R(no arm) –H/T– R(1arm&RHF)

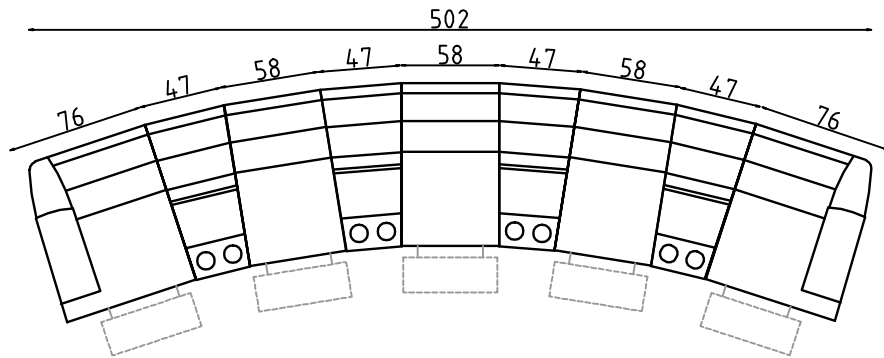

1. 5R(1arm&LHF)–H/T –1. 5R(no arm)–H/T –1. 5R(no arm) –H/T–1. 5R(no arm)–H/T– 1. 5R(1arm&RHF)

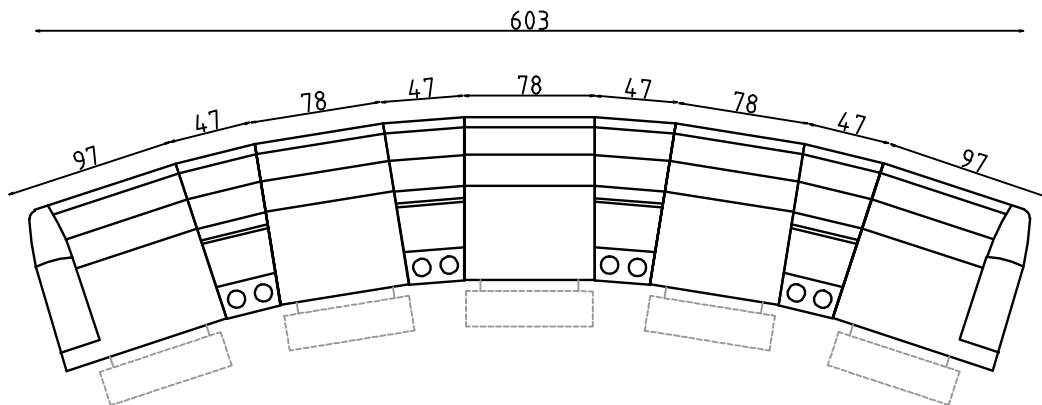

Please note lounge is hand made product. This is just indication for measurement. Sometimes our specifications change. Our line drawing includes specifications which are current at the time of printing. However, improvements or alterations to design, construction or techniques or dimensions may occur.